



## RACORERÍA HIDRÁULICA

Conexiones roscadas BSP – JIC – SAE – METRICO – ORFS

DN



## > RA2114

### RACOR MACHO FIJO ROSCA BSP CONO 60°

ISO 8436-6

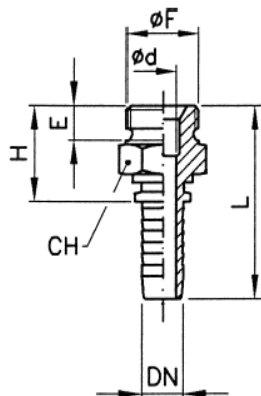

**Rosca:** Gas perfil Whitworth

**Cono:** BSP 60°

**Tratamiento exterior:**  
galvanizado blanco trivalente

**Aplicación:** Fluidos hidráulicos,  
agua-glicol, agua, aire

| DN     | Referencia   | Ø F        | CH | Ø d  | H    | E  | L     | K |
|--------|--------------|------------|----|------|------|----|-------|---|
| 1/4"   | RA2114-4     | 1/4"-19h   | 19 | 4    | 25.7 | 11 | 53    |   |
| 1/4"   | RA2114-6-4   | 3/8"-19h   | 22 | 4    | 27.2 | 12 | 54.5  |   |
| 5/16"  | RA2114-6-5   | 3/8"-19h   | 22 | 5.5  | 28   | 12 | 56.5  |   |
| 3/8"   | RA2114-6     | 3/8"-19h   | 22 | 7    | 28   | 12 | 56.5  |   |
| 3/8"   | RA2114-8-6   | 1/2"-14h   | 27 | 7    | 31   | 14 | 59.5  |   |
| 1/2"   | RA2114-8     | 1/2"-14h   | 27 | 10   | 31.5 | 14 | 61.5  |   |
| 1/2"   | RA2114-10-8  | 5/8"-14h   | 30 | 10   | 33.5 | 16 | 63.5  |   |
| 5/8"   | RA2114-10    | 5/8"-14h   | 30 | 12.2 | 33.5 | 16 | 66.5  |   |
| 5/8"   | RA2114-12-10 | 3/4"-14h   | 32 | 12.5 | 34.5 | 16 | 67.5  |   |
| 3/4"   | RA2114-12    | 3/4"-14h   | 32 | 15.5 | 35.5 | 16 | 74.5  |   |
| 3/4"   | RA2114-16-12 | 1"-11h     | 41 | 15.5 | 39.5 | 16 | 78.5  |   |
| 1"     | RA2114-16    | 1"-11h     | 41 | 20   | 40   | 19 | 92.5  |   |
| 1"     | RA2114-20-16 | 1.1/4"-11h | 50 | 20   | 44   | 19 | 96.5  |   |
| 1.1/4" | RA2114-20    | 1.1/4"-11h | 50 | 26   | 45.5 | 20 | 105.5 |   |
| 1.1/4" | RA2114-24-20 | 1.1/2"-11h | 55 | 26   | 47.5 | 22 | 107.5 |   |
| 1.1/2" | RA2114-24    | 1.1/2"-11h | 55 | 32   | 47.5 | 22 | 117.5 |   |
| 2"     | RA2114-32    | 2"-11h     | 70 | 44   | 52   | 25 | 126.5 |   |

## > RA2234

### RACOR HEMBRA GIRATORIA ROSCA BSP CONO 60°

ISO 8436-6

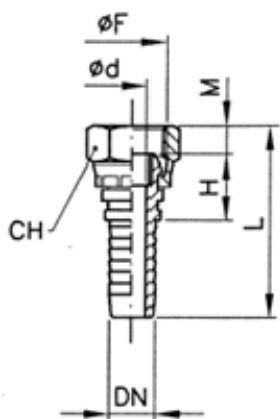

**Rosca:** Gas perfil Whitworth

**Cono:** BSP 60°

**Tratamiento exterior:**  
galvanizado blanco trivalente

**Aplicación:** Fluidos hidráulicos,  
agua-glicol, agua, aire

| DN     | Referencia   | Ø F        | CH | Ø d  | H    | M    | L     | K |
|--------|--------------|------------|----|------|------|------|-------|---|
| 1/4"   | RA2234-4     | 1/4"-19h   | 19 | 4    | 16.7 | 5    | 49    |   |
| 1/4"   | RA2234-6-4   | 3/8"-19h   | 22 | 4    | 18.7 | 6    | 52    |   |
| 5/16"  | RA2234-6-5   | 3/8"-19h   | 22 | 5.5  | 20   | 6    | 54.5  |   |
| 3/8"   | RA2234-6     | 3/8"-19h   | 22 | 7    | 20   | 6    | 54.5  |   |
| 3/8"   | RA2234-8-6   | 1/2"-14h   | 27 | 7    | 22   | 6    | 56.5  |   |
| 1/2"   | RA2234-8     | 1/2"-14h   | 27 | 10   | 22.5 | 6    | 58.5  |   |
| 5/8"   | RA2234-10    | 5/8"-14h   | 28 | 12.5 | 24   | 6.5  | 63.5  |   |
| 5/8"   | RA2234-12-10 | 3/4"-14h   | 32 | 12.5 | 24   | 7.5  | 64.5  |   |
| 3/4"   | RA2234-12    | 3/4"-14h   | 32 | 15.5 | 25.5 | 7.5  | 72    |   |
| 3/4"   | RA2234-16-12 | 1"-11h     | 38 | 15.5 | 26   | 10   | 75    |   |
| 1"     | RA2234-16    | 1"-11h     | 38 | 20   | 26.5 | 10   | 89    |   |
| 1"     | RA2234-20-16 | 1.1/4"-11h | 50 | 20   | 32.5 | 11.5 | 96.5  |   |
| 1.1/4" | RA2234-20    | 1.1/4"-11h | 50 | 26   | 33   | 11.5 | 102.5 |   |
| 1.1/4" | RA2234-24-20 | 1.1/2"-11h | 55 | 26   | 35   | 11   | 106   |   |
| 1.1/2" | RA2234-24    | 1.1/2"-11h | 55 | 32   | 31   | 16   | 117   |   |
| 2"     | RA2234-32    | 2"-11h     | 70 | 32   | 31   | 16   | 117   |   |

## > RA2904

### RACOR HEMBRA GIRATORIA CODO 90° ROSCA BSP CONO 60°

ISO 8436-6

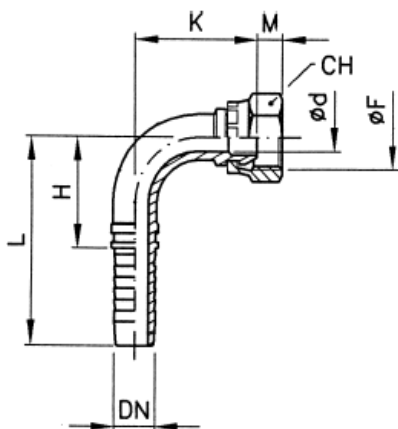

**Rosca:** Gas perfil Whitworth

**Cono:** BSP 60°

**Tratamiento exterior:**  
galvanizado blanco trivalente

**Aplicación:** Fluidos hidráulicos,  
agua-glicol, agua, aire

| DN     | Referencia   | Ø F        | CH | Ø d  | H    | M    | L     | K     |
|--------|--------------|------------|----|------|------|------|-------|-------|
| 1/4"   | RA2904-4     | 1/4"-19h   | 19 | 4    | 23   | 5    | 50.5  | 28    |
| 1/4"   | RA2904-6-4   | 3/8"-19h   | 22 | 4    | 23   | 6    | 50.5  | 31    |
| 5/16"  | RA2904-6-5   | 3/8"-19h   | 22 | 5.5  | 26   | 6    | 54.5  | 32.5  |
| 3/8"   | RA2904-6     | 3/8"-19h   | 22 | 7    | 30.5 | 6    | 59    | 37    |
| 3/8"   | RA2904-8-6   | 1/2"-14h   | 27 | 7    | 30.5 | 6    | 59    | 39.5  |
| 1/2"   | RA2904-8     | 1/2"-14h   | 27 | 10   | 38   | 6    | 68    | 43.5  |
| 5/8"   | RA2904-10    | 5/8"-14h   | 28 | 12.5 | 44.5 | 6.5  | 77.5  | 51.5  |
| 5/8"   | RA2904-12-10 | 3/4"-14h   | 32 | 12.5 | 44.5 | 7.5  | 77.5  | 51.5  |
| 3/4"   | RA2904-12    | 3/4"-14h   | 32 | 15.5 | 54   | 7.5  | 93    | 58    |
| 3/4"   | RA2904-16-12 | 1"-11h     | 38 | 15.5 | 54   | 10   | 93    | 60.5  |
| 1"     | RA2904-16    | 1"-11h     | 38 | 20   | 74   | 10   | 126.5 | 70.5  |
| 1"     | RA2904-20-16 | 1.1/4"-11h | 50 | 20   | 74   | 11.5 | 126.5 | 78.5  |
| 1.1/4" | RA2904-20    | 1.1/4"-11h | 50 | 26   | 80   | 11.5 | 140   | 88.5  |
| 1.1/4" | RA2904-24-20 | 1.1/2"-11h | 55 | 26   | 80   | 11   | 140   | 91.5  |
| 1.1/2" | RA2904-24    | 1.1/2"-11h | 55 | 32   | 93   | 16   | 140   | 103.5 |
| 2"     | RA2904-32    | 2"-11h     | 70 | 32   | 129  | 16   | 203.5 | 124   |

## > RA2454

### RACOR HEMBRA GIRATORIA CODO 45° ROSCA BSP CONO 60°

ISO 8436-6

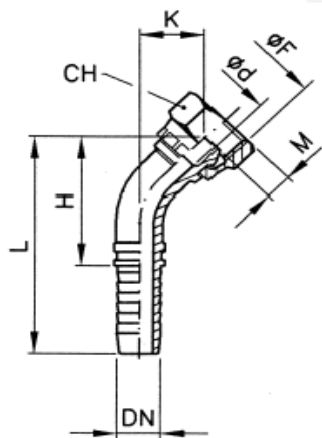

**Rosca:** Gas perfil Whitworth

**Cono:** BSP 60°

**Tratamiento exterior:**  
galvanizado blanco trivalente

**Aplicación:** Fluidos hidráulicos,  
agua-glicol, agua, aire

| DN     | Referencia   | Ø F        | CH | Ø d  | H     | M    | L     | K    |
|--------|--------------|------------|----|------|-------|------|-------|------|
| 1/4"   | RA2454-4     | 1/4"-19h   | 19 | 4    | 37.5  | 5    | 65    | 14.5 |
| 1/4"   | RA2454-6-4   | 3/8"-19h   | 22 | 4    | 39.5  | 6    | 67    | 14   |
| 5/16"  | RA2454-6-5   | 3/8"-19h   | 22 | 5.5  | 44    | 6    | 72.5  | 14   |
| 3/8"   | RA2454-6     | 3/8"-19h   | 22 | 7    | 50    | 6    | 78.5  | 19   |
| 3/8"   | RA2454-8-6   | 1/2"-14h   | 27 | 7    | 52    | 6    | 80.5  | 20.5 |
| 1/2"   | RA2454-8     | 1/2"-14h   | 27 | 10   | 62    | 6    | 92    | 21.5 |
| 5/8"   | RA2454-10    | 5/8"-14h   | 28 | 12.5 | 72.5  | 6.5  | 105.5 | 25.5 |
| 5/8"   | RA2454-12-10 | 3/4"-14h   | 32 | 12.5 | 72.5  | 7.5  | 105.5 | 25.5 |
| 3/4"   | RA2454-12    | 3/4"-14h   | 32 | 15.5 | 64    | 7.5  | 103   | 28   |
| 3/4"   | RA2454-16-12 | 1"-11h     | 38 | 15.5 | 65.5  | 10   | 104.5 | 30   |
| 1"     | RA2454-16    | 1"-11h     | 38 | 20   | 85    | 10   | 137.5 | 33   |
| 1"     | RA2454-20-16 | 1.1/4"-11h | 50 | 20   | 90.5  | 11.5 | 143   | 39   |
| 1.1/4" | RA2454-20    | 1.1/4"-11h | 50 | 26   | 99.5  | 11.5 | 159.5 | 42   |
| 1.1/2" | RA2454-24    | 1.1/2"-11h | 55 | 32   | 112   | 16   | 182   | 48   |
| 2"     | RA2454-32    | 2"-11h     | 70 | 32   | 132.5 | 16   | 207   | 52.5 |



## > RA2115

### RACOR MACHO FIJO ROSCA NPT

SAE J516 – SAE J518

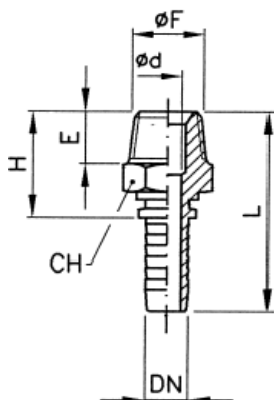

Rosca: NPT cónica

Cono:

Tratamiento exterior:  
galvanizado blanco trivalente

Aplicación: Fluidos hidráulicos,  
agua-glicol, agua, aire

| DN     | Referencia   | Ø F         | CH | Ø d  | H    | E    | L     | K |
|--------|--------------|-------------|----|------|------|------|-------|---|
| 1/4"   | RA2115-2-4   | 1/8"-27     | 12 | 4    | 21.5 | 10   | 48.8  |   |
| 1/4"   | RA2115-4     | 1/4"-18     | 14 | 4    | 26.5 | 14.2 | 53.8  |   |
| 1/4"   | RA2115-6-4   | 3/8"-18     | 19 | 4    | 27.5 | 14.2 | 54.8  |   |
| 3/8"   | RA2115-6     | 3/8"-18     | 19 | 7    | 28   | 14.2 | 56.5  |   |
| 3/8"   | RA2115-8-6   | 1/2"-14     | 22 | 7    | 34   | 19   | 62.5  |   |
| 1/2"   | RA2115-8     | 1/2"-14     | 22 | 10   | 34.5 | 19   | 64.5  |   |
| 5/8"   | RA2115-12-10 | 3/4"-14     | 27 | 12.5 | 36.5 | 19   | 69.5  |   |
| 3/4"   | RA2115-12    | 3/4"-14     | 27 | 15.5 | 37.5 | 19   | 76.5  |   |
| 1"     | RA2115-16    | 1"-11.5     | 36 | 20   | 43.5 | 23.9 | 96    |   |
| 1.1/4" | RA2115-20    | 1.1/4"-11.5 | 46 | 26   | 46.5 | 24.6 | 106.5 |   |
| 1.1/2" | RA2115-24    | 1.1/2"-11.5 | 50 | 32   | 50   | 25.4 | 120   |   |
| 2"     | RA2115-32    | 2"-11.5     | 65 | 44   | 54.5 | 26.5 | 129   |   |
|        |              |             |    |      |      |      |       |   |
|        |              |             |    |      |      |      |       |   |
|        |              |             |    |      |      |      |       |   |
|        |              |             |    |      |      |      |       |   |

## > RA2124

### RACOR MACHO FIJO ROSCA BSPT

GAS CÓNICO

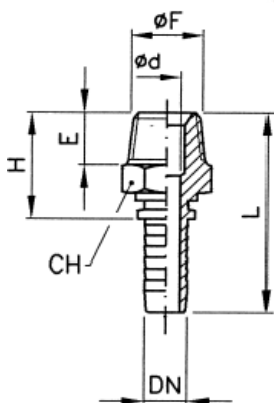

Rosca: GAS cónica

Cono:

Tratamiento exterior:  
galvanizado blanco trivalente

Aplicación: Fluidos hidráulicos,  
agua-glicol, agua, aire

| DN     | Referencia | Ø F       | CH | Ø d  | H    | E  | L     | K |
|--------|------------|-----------|----|------|------|----|-------|---|
| 1/4"   | RA2124-4   | 1/4"-19   | 14 | 4    | 26   | 13 | 53.3  |   |
| 1/4"   | RA2124-6-4 | 3/8"-19   | 19 | 4    | 27   | 13 | 54.3  |   |
| 5/16"  | RA2124-6-5 | 3/8"-19   | 19 | 5.5  | 27.5 | 13 | 56    |   |
| 3/8"   | RA2124-6   | 3/8"-19   | 19 | 7    | 28   | 13 | 56.5  |   |
| 3/8"   | RA2124-8-6 | 1/2"-14   | 22 | 7    | 31.5 | 16 | 60    |   |
| 1/2"   | RA2124-8   | 1/2"-14   | 22 | 10   | 32   | 16 | 62    |   |
| 3/4"   | RA2124-12  | 3/4"-14   | 27 | 15.5 | 38   | 18 | 77    |   |
| 1"     | RA2124-16  | 1"-11     | 36 | 20   | 41   | 20 | 93.5  |   |
| 1.1/4" | RA2124-20  | 1.1/4"-11 | 46 | 26   | 45.5 | 21 | 105.5 |   |
| 1.1/2" | RA2124-24  | 1.1/2"-11 | 50 | 32   | 49   | 22 | 119   |   |
| 2"     | RA2124-32  | 2"-11     | 65 | 44   | 53.5 | 23 | 128   |   |
|        |            |           |    |      |      |    |       |   |
|        |            |           |    |      |      |    |       |   |
|        |            |           |    |      |      |    |       |   |
|        |            |           |    |      |      |    |       |   |

## > RA2222

### RACOR MACHO FIJO ROSCA JIC CONO 74°

SAE J514 - ISO 8434-2 / ISO12151-8

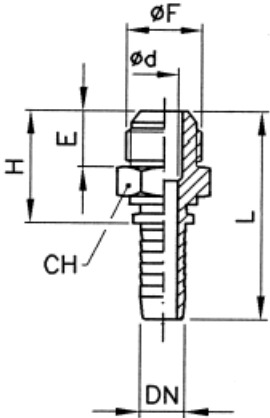

**Rosca:** SAE perfil Sellers

**Cono:** JIC 74°

**Tratamiento exterior:**  
galvanizado blanco trivalente

**Aplicación:** Fluidos hidráulicos,  
agua-glicol, agua, aire

| DN     | Referencia   | Ø F         | CH | Ø d  | H    | E    | L     | K |
|--------|--------------|-------------|----|------|------|------|-------|---|
| 1/4"   | RA2222-4     | 7/16"-20h   | 14 | 4    | 27.5 | 14   | 54.8  |   |
| 1/4"   | RA2222-5-4   | 1/2"-20h    | 14 | 4    | 27.5 | 14   | 54.8  |   |
| 1/4"   | RA2222-6-4   | 9/16"-18h   | 17 | 4    | 27.7 | 14.1 | 55    |   |
| 5/16"  | RA2222-6-5   | 9/16"-18h   | 17 | 5.5  | 28.5 | 14.1 | 57    |   |
| 3/8"   | RA2222-6     | 9/16"-18h   | 17 | 7    | 28.5 | 14.1 | 57    |   |
| 3/8"   | RA2222-8-6   | 3/4"-16h    | 19 | 7    | 32   | 16.7 | 60.5  |   |
| 1/2"   | RA2222-8     | 3/4"-16h    | 19 | 10   | 32.5 | 16.7 | 62.5  |   |
| 1/2"   | RA2222-10-8  | 7/8"-14h    | 24 | 10   | 36.5 | 19.3 | 66.5  |   |
| 5/8"   | RA2222-10    | 7/8"-14h    | 24 | 12.5 | 36.5 | 19.3 | 69.5  |   |
| 1/2"   | RA2222-12-8  | 1.1/6"-12h  | 27 | 10   | 38.5 | 21.9 | 68.5  |   |
| 5/8"   | RA2222-12-10 | 1.1/6"-12h  | 27 | 12.5 | 38.5 | 21.9 | 71    |   |
| 3/4"   | RA2222-12    | 1.1/6"-12h  | 27 | 15.5 | 39.5 | 21.9 | 78.5  |   |
| 3/4"   | RA2222-16-12 | 1.5/16"-12h | 36 | 15.5 | 41.5 | 23.1 | 80.5  |   |
| 1"     | RA2222-16    | 1.5/16"-12h | 36 | 20   | 42   | 23.1 | 94.5  |   |
| 1.1/4" | RA2222-20    | 1.5/8"-12h  | 46 | 26   | 48.5 | 24.3 | 108.5 |   |
| 1.1/2" | RA2222-24    | 1.7/8"-12h  | 50 | 32   | 53.5 | 27.5 | 123.5 |   |
|        |              |             |    |      |      |      |       |   |
|        |              |             |    |      |      |      |       |   |

## > RA2122

### RACOR HEMBRA GIRATORIA ROSCA JIC CONO 74°

SAE J514 - ISO 8434-2 / ISO12151-8

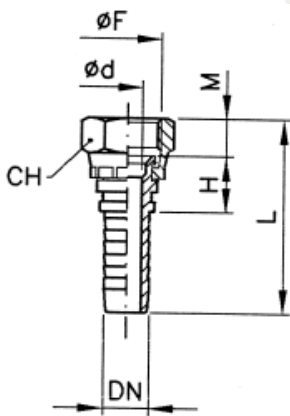

**Rosca:** SAE perfil Sellers

**Cono:** JIC 74°

**Tratamiento exterior:**  
galvanizado blanco trivalente

**Aplicación:** Fluidos hidráulicos,  
agua-glicol, agua, aire

| DN     | Referencia   | Ø F         | CH | Ø d  | H    | M    | L     | K |
|--------|--------------|-------------|----|------|------|------|-------|---|
| 1/4"   | RA2122-4     | 7/16"-20h   | 17 | 4    | 14.7 | 7.5  | 49.5  |   |
| 1/4"   | RA2122-5-4   | 1/2"-20h    | 19 | 4    | 16.7 | 8.5  | 52.5  |   |
| 1/4"   | RA2122-6-4   | 9/16"-18h   | 19 | 4    | 16.7 | 9.5  | 53.5  |   |
| 5/16"  | RA2122-6-5   | 9/16"-18h   | 19 | 5.5  | 18   | 9.5  | 56    |   |
| 3/8"   | RA2122-6     | 9/16"-18h   | 19 | 7    | 18   | 9.5  | 56    |   |
| 3/8"   | RA2122-8-6   | 3/4"-16h    | 24 | 7    | 20   | 11.5 | 60    |   |
| 1/2"   | RA2122-8     | 3/4"-16h    | 24 | 7    | 21   | 11.5 | 62.5  |   |
| 1/2"   | RA2122-10-8  | 7/8"-14h    | 27 | 10   | 20.5 | 14   | 64.5  |   |
| 5/8"   | RA2122-10    | 7/8"-14h    | 27 | 12.5 | 20.5 | 14   | 67.5  |   |
| 1/2"   | RA2122-12-8  | 1.1/6"-12h  | 32 | 10   | 21.5 | 14.5 | 66    |   |
| 5/8"   | RA2122-12-10 | 1.1/6"-12h  | 32 | 12.5 | 22   | 14.5 | 69.5  |   |
| 3/4"   | RA2122-12    | 1.1/6"-12h  | 32 | 15.5 | 23.5 | 14.5 | 77    |   |
| 3/4"   | RA2122-16-12 | 1.5/16"-12h | 38 | 15.5 | 24.5 | 14.5 | 78    |   |
| 1"     | RA2122-16    | 1.5/16"-12h | 38 | 20   | 25   | 14.5 | 92    |   |
| 1.1/4" | RA2122-20    | 1.5/8"-12h  | 50 | 26   | 29   | 16.5 | 105.5 |   |
| 1.1/2" | RA2122-24    | 1.7/8"-12h  | 55 | 32   | 29.5 | 18   | 117.5 |   |
|        |              |             |    |      |      |      |       |   |
|        |              |             |    |      |      |      |       |   |



## > RA2903

### RACOR HEMBRA GIRATORIA CODO 90° ROSCA JIC CONO 74°

SAE J514 - ISO 8434-2 / ISO12151-8

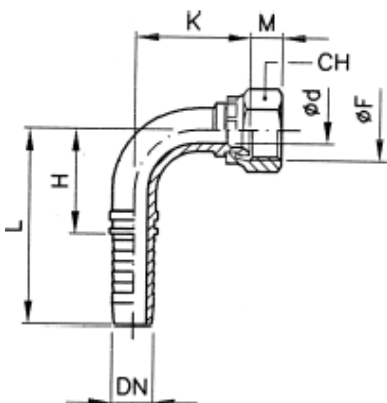

**Rosca:** SAE perfil Sellers

**Cono:** JIC 74°

**Tratamiento exterior:**  
galvanizado blanco trivalente

**Aplicación:** Fluidos hidráulicos,  
agua-glicol, agua, aire

| DN     | Referencia   | Ø F         | CH | Ø d  | H    | M    | L    | K    |
|--------|--------------|-------------|----|------|------|------|------|------|
| 1/4"   | RA2903-4     | 7/16"-20h   | 17 | 4    | 23   | 7.5  | 50.5 | 26   |
| 1/4"   | RA2903-5-4   | 1/2"-20h    | 19 | 4    | 23   | 8.5  | 50.5 | 28.5 |
| 1/4"   | RA2903-6-4   | 9/16"-18h   | 19 | 4    | 23   | 9.5  | 50.5 | 28.5 |
| 5/16"  | RA2903-6-5   | 9/16"-18h   | 19 | 5.5  | 26   | 9.5  | 24.5 | 30.5 |
| 3/8"   | RA2903-6     | 9/16"-18h   | 19 | 7    | 30.5 | 9.5  | 59   | 35   |
| 3/8"   | RA2903-8-6   | 3/4"-16h    | 24 | 7    | 30.5 | 11.5 | 59   | 38   |
| 1/2"   | RA2903-8     | 3/4"-16h    | 24 | 7    | 38   | 11.5 | 68   | 42   |
| 1/2"   | RA2903-10-8  | 7/8"-14h    | 27 | 10   | 38   | 14   | 68   | 41.5 |
| 5/8"   | RA2903-10    | 7/8"-14h    | 27 | 12.5 | 44.5 | 14   | 77.5 | 48   |
| 5/8"   | RA2903-12-10 | 1.1/6"-12h  | 32 | 12.5 | 54   | 14.5 | 77.5 | 49.5 |
| 3/4"   | RA2903-12    | 1.1/6"-12h  | 32 | 15.5 | 54   | 14.5 | 93   | 59   |
| 3/4"   | RA2903-16-12 | 1.5/16"-12h | 38 | 15.5 | 54   | 14.5 | 93   | 59   |
| 1"     | RA2903-16    | 1.5/16"-12h | 38 | 20   | 74.5 | 14.5 | 127  | 69   |
| 1.1/4" | RA2903-20    | 1.5/8"-12h  | 50 | 26   | 80   | 16.5 | 140  | 84.5 |
| 1.1/2" | RA2903-24    | 1.7/8"-12h  | 55 | 32   | 104  | 18   | 174  | 98   |
| 1/4"   | RA2903-4     | 7/16"-20h   | 17 | 4    | 23   | 7.5  | 50.5 | 26   |

## > RA2453

### RACOR HEMBRA GIRATORIA CODO 45° ROSCA JIC CONO 74°

SAE J514 - ISO 8434-2 / ISO12151-8

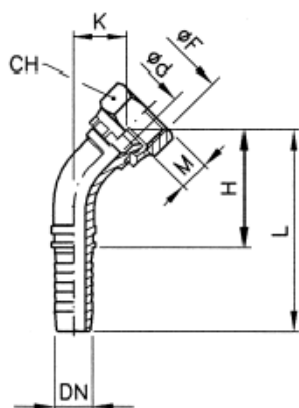

**Rosca:** SAE perfil Sellers

**Cono:** JIC 74°

**Tratamiento exterior:**  
galvanizado blanco trivalente

**Aplicación:** Fluidos hidráulicos,  
agua-glicol, agua, aire

| DN     | Referencia   | Ø F         | CH | Ø d  | H    | M     | L    | K    |
|--------|--------------|-------------|----|------|------|-------|------|------|
| 1/4"   | RA2453-4     | 7/16"-20h   | 17 | 4    | 36   | 63.5  | 13.5 | 7.5  |
| 1/4"   | RA2453-5-4   | 1/2"-20h    | 19 | 4    | 38   | 65.5  | 15   | 8.5  |
| 1/4"   | RA2453-6-4   | 9/16"-18h   | 19 | 4    | 38   | 65.5  | 15   | 9.5  |
| 5/16"  | RA2453-6-5   | 9/16"-18h   | 19 | 5.5  | 42.5 | 71    | 15.5 | 9.5  |
| 3/8"   | RA2453-6     | 9/16"-18h   | 19 | 7    | 49   | 77.5  | 17.5 | 9.5  |
| 3/8"   | RA2453-8-6   | 3/4"-16h    | 24 | 7    | 51   | 79.5  | 19.5 | 11.5 |
| 1/2"   | RA2453-8     | 3/4"-16h    | 24 | 7    | 60.5 | 90.5  | 20.5 | 11.5 |
| 1/2"   | RA2453-10-8  | 7/8"-14h    | 27 | 10   | 60.5 | 90.5  | 20   | 14   |
| 5/8"   | RA2453-10    | 7/8"-14h    | 27 | 12.5 | 70   | 103   | 23   | 14   |
| 5/8"   | RA2453-12-10 | 1.1/6"-12h  | 32 | 12.5 | 71   | 104   | 24   | 14.5 |
| 3/4"   | RA2453-12    | 1.1/6"-12h  | 32 | 15.5 | 62.5 | 101.5 | 26.5 | 14.5 |
| 1"     | RA2453-16    | 1.5/16"-12h | 38 | 20   | 84.5 | 137   | 32   | 14.5 |
| 1.1/4" | RA2453-20    | 1.5/8"-12h  | 50 | 26   | 97   | 157   | 39.5 | 16.5 |
| 1.1/2" | RA2453-24    | 1.7/8"-12h  | 55 | 32   | 110  | 180   | 44.5 | 18   |

## > RA2MORS

### RACOR MACHO FIJO ROSCA ORFS

ISO 8434-3 / ISO 12151-1

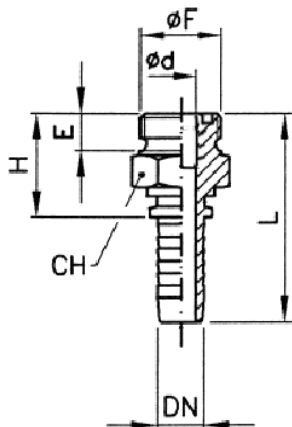

Rosca: SAE perfil Sellers

Cono: Asiento plano c/junta

Tratamiento exterior: galvanizado blanco trivalente

Aplicación: Fluidos hidráulicos, agua-glicol, agua, aire

| DN     | Referencia   | Ø F         | CH | Ø d  | H    | E    | L    |
|--------|--------------|-------------|----|------|------|------|------|
| 1/4"   | RA2MORS-4    | 9/16"-18h   | 17 | 4    | 22.5 | 14.5 | 50.5 |
| 1/4"   | RA2MORS-6-4  | 11/16"-16h  | 19 | 4    | 25   | 15   | 53   |
| 5/16"  | RA2MORS-6-5  | 11/16"-16h  | 19 | 5.5  | 25.5 | 15   | 53.5 |
| 3/8"   | RA2MORS-6    | 11/16"-16h  | 19 | 7    | 25.5 | 15.5 | 55   |
| 1/2"   | RA2MORS-8    | 13/16"-16h  | 22 | 10   | 29.5 | 17.5 | 59   |
| 1/2"   | RA2MORS-10-8 | 1"-14h      | 27 | 10   | 31   | 18.5 | 60.5 |
| 5/8"   | RA2MORS-10   | 1"-14h      | 27 | 12.5 | 31.3 | 22   | 65.3 |
| 3/4"   | RA2MORS-12   | 1.3/16"-12h | 32 | 15.5 | 34   | 26   | 73   |
| 1"     | RA2MORS-16   | 1.7/16"-12h | 41 | 20   | 36.5 | 29.5 | 83.5 |
| 1.1/4" | RA2MORS-20   | 1.11/16"-   | 46 | 26   | 38.5 | 33.5 | 93   |

## > RA2ORS

### RACOR HEMBRA GIRATORIA ROSCA ORFS

ISO 8434-3 / ISO 12151-1

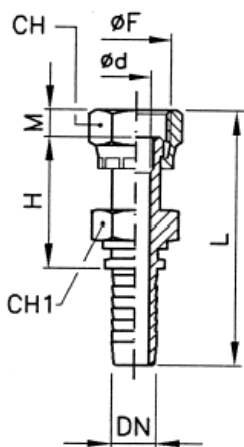

Rosca: SAE perfil Sellers

Cono: Asiento plano

Tratamiento exterior: galvanizado blanco trivalente

Aplicación: Fluidos hidráulicos, agua-glicol, agua, aire

| DN     | Referencia  | Ø F          | CH | CH1 | Ø d  | H    | M    | L    |
|--------|-------------|--------------|----|-----|------|------|------|------|
| 1/4"   | RA2ORS-4    | 9/16"-18h    | 17 | 14  | 4    | 28   | 8    | 63   |
| 1/4"   | RA2ORS-6-4  | 11/16"-16h   | 22 | 17  | 4    | 30.5 | 9.5  | 67.5 |
| 5/16"  | RA2ORS-6-5  | 11/16"-16h   | 22 | 17  | 5.5  | 31   | 9.5  | 69   |
| 3/8"   | RA2ORS-6    | 11/16"-16h   | 22 | 17  | 7    | 31   | 9.5  | 69   |
| 1/2"   | RA2ORS-8    | 13/16"-16h   | 24 | 19  | 10   | 36.5 | 11   | 77   |
| 1/2"   | RA2ORS-10-8 | 1"-14h       | 30 | 24  | 10   | 36.5 | 13.5 | 82.5 |
| 5/8"   | RA2ORS-10   | 1"-14h       | 30 | 25  | 12.5 | 39.5 | 13.5 | 85.5 |
| 3/4"   | RA2ORS-12   | 1.3/16"-12h  | 36 | 30  | 15.5 | 43.5 | 14.5 | 97   |
| 1"     | RA2ORS-16   | 1.7/16"-12h  | 41 | 36  | 20   | 46.5 | 15   | 114  |
| 1.1/4" | RA2ORS-20   | 1.11/16"-12h | 50 | 41  | 26   | 49   | 15   | 124  |







## > RA2901

### RACOR HEMBRA GIRATORIA CODO 90° ROSCA METRICA CONO 60°

DIN 3868

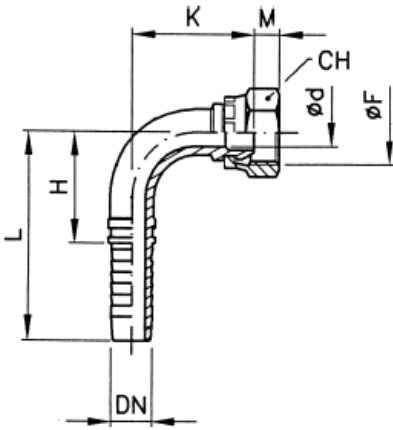

Rosca: Métrica

Cono: 60°

Tratamiento exterior:  
galvanizado blanco trivalente

Aplicación: Fluidos hidráulicos,  
agua-glicol, agua, aire

| DN    | Referencia   | Ø F     | CH | Ø d  | H    | M   | L     | K    |
|-------|--------------|---------|----|------|------|-----|-------|------|
| 1/4"  | RA2901-6-4   | M14x150 | 19 | 4    | 23   | 3.5 | 50.5  | 29   |
| 1/4"  | RA2901-8-4   | M16x150 | 22 | 4    | 23   | 5.5 | 50.5  | 21   |
| 5/16" | RA2901-8-5   | M16x150 | 22 | 5.5  | 26   | 5.5 | 54.5  | 32.5 |
| 3/8"  | RA2901-8-6   | M16x150 | 22 | 7    | 30.5 | 5.5 | 59    | 37   |
| 5/16" | RA2901-10-5  | M18x150 | 24 | 5.5  | 26   | 4   | 54.5  | 34.5 |
| 3/8"  | RA2901-10-6  | M18x150 | 24 | 7    | 30.5 | 4   | 59    | 39   |
| 3/8"  | RA2901-12-6  | M20x150 | 27 | 7    | 30.5 | 5.5 | 59    | 39.5 |
| 3/8"  | RA2901-13-6  | M22x150 | 27 | 7    | 30.5 | 3.5 | 59    | 43   |
| 1/2"  | RA2901-13-8  | M22x150 | 27 | 10   | 38   | 5.5 | 68    | 47   |
| 5/8"  | RA2901-16-10 | M26x150 | 32 | 12.5 | 44.5 | 5.5 | 77.5  | 51.5 |
| 3/4"  | RA2901-16-12 | M26x150 | 32 | 15.5 | 54   | 5.5 | 93    | 58   |
| 3/4"  | RA2901-20-12 | M30x150 | 36 | 15.5 | 54   | 5.5 | 93    | 64.5 |
| 1"    | RA2901-25-16 | M38x150 | 46 | 20   | 74   | 6.5 | 126.5 | 79.5 |
|       |              |         |    |      |      |     |       |      |
|       |              |         |    |      |      |     |       |      |
|       |              |         |    |      |      |     |       |      |
|       |              |         |    |      |      |     |       |      |

## > RA2451

### RACOR HEMBRA GIRATORIA CODO 45° ROSCA METRICA CONO 60°

DIN 3868

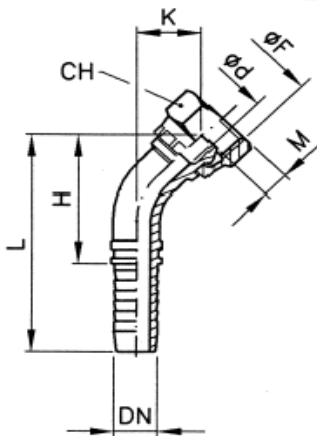

Rosca: Métrica

Cono: 60°

Tratamiento exterior:  
galvanizado blanco trivalente

Aplicación: Fluidos hidráulicos,  
agua-glicol, agua, aire

| DN    | Referencia   | Ø F     | CH | Ø d  | H    | M   | L     | K    |
|-------|--------------|---------|----|------|------|-----|-------|------|
| 1/4"  | RA2451-6-4   | M14x150 | 19 | 4    | 38   | 3.5 | 65.5  | 15.5 |
| 1/4"  | RA2451-8-4   | M16x150 | 22 | 4    | 39.5 | 5.5 | 67    | 17   |
| 5/16" | RA2451-8-5   | M16x150 | 22 | 5.5  | 44   | 5.5 | 72.5  | 17   |
| 3/8"  | RA2451-8-6   | M16x150 | 22 | 7    | 50   | 5.5 | 78.5  | 19   |
| 5/16" | RA2451-10-5  | M18x150 | 24 | 5.5  | 45   | 4   | 73.5  | 18.5 |
| 3/8"  | RA2451-10-6  | M18x150 | 24 | 7    | 51.5 | 4   | 80    | 20   |
| 3/8"  | RA2451-12-6  | M20x150 | 27 | 7    | 52   | 5.5 | 80.5  | 20.5 |
| 3/8"  | RA2451-13-6  | M22x150 | 27 | 7    | 54   | 3.5 | 82.5  | 23   |
| 1/2"  | RA2451-13-8  | M22x150 | 27 | 10   | 64   | 5.5 | 94    | 24   |
| 5/8"  | RA2451-16-10 | M26x150 | 32 | 12.5 | 72.5 | 5.5 | 105.5 | 25.5 |
| 3/4"  | RA2451-16-12 | M26x150 | 32 | 15.5 | 64   | 5.5 | 103   | 28   |
| 3/4"  | RA2451-20-12 | M30x150 | 36 | 15.5 | 68.5 | 5.5 | 107.5 | 32.5 |
| 1"    | RA2451-25-16 | M38x150 | 46 | 20   | 91.5 | 6.5 | 144   | 39.5 |
|       |              |         |    |      |      |     |       |      |
|       |              |         |    |      |      |     |       |      |
|       |              |         |    |      |      |     |       |      |
|       |              |         |    |      |      |     |       |      |

## > RA2133

### RACOR MACHO FIJO ROSCA METRICA CONO 24° SERIE LIGERA (DKOL)

DIN 2353 – ISO 8434-1 / ISO 12151-2

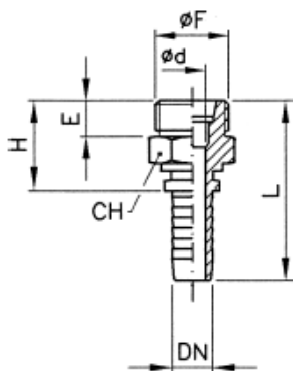

Rosca: Métrica

Cono: 24° SERIE LIGERA

Tratamiento exterior:  
galvanizado blanco trivalente

Aplicación: Fluidos hidráulicos,  
agua-glicol, agua, aire

| DN     | Referencia   | ø F      | ø DIN | CH | ø d  | H    | E  | L    | K |
|--------|--------------|----------|-------|----|------|------|----|------|---|
| 1/4"   | RA2133-6-4   | M-12x150 | 6L    | 14 | 4    | 21.7 | 10 | 49   |   |
| 1/4"   | RA2133-8-4   | M-14x150 | 8L    | 14 | 4    | 21.7 | 10 | 49   |   |
| 1/4"   | RA2133-10-4  | M-16x150 | 10L   | 17 | 4    | 22.7 | 11 | 50   |   |
| 5/16"  | RA2133-10-5  | M-16x150 | 10L   | 17 | 5.5  | 23.5 | 11 | 52   |   |
| 3/8"   | RA2133-10-6  | M-16x150 | 10L   | 17 | 7    | 22.7 | 11 | 51.2 |   |
| 5/16"  | RA2133-12-5  | M-18x150 | 12L   | 19 | 5.5  | 24.5 | 11 | 53   |   |
| 3/8"   | RA2133-12-6  | M-18x150 | 12L   | 19 | 7    | 24.5 | 11 | 53   |   |
| 3/8"   | RA2133-15-6  | M-22x150 | 15L   | 22 | 7    | 26   | 12 | 54.5 |   |
| 1/2"   | RA2133-15-8  | M-22x150 | 15L   | 22 | 10   | 26   | 12 | 56   |   |
| 5/8"   | RA2133-18-10 | M-26x150 | 18L   | 27 | 12.5 | 27   | 12 | 60   |   |
| 3/4"   | RA2133-22-12 | M-30x200 | 22L   | 32 | 15.5 | 30   | 14 | 69   |   |
| 1"     | RA2133-28-16 | M-36x200 | 28L   | 41 | 20   | 32.5 | 14 | 85   |   |
| 1.1/4" | RA2133-35-20 | M-42x200 | 35L   | 46 | 26   | 39   | 16 | 99   |   |
| 1.1/2" | RA2133-42-24 | M-52x200 | 42L   | 55 | 32   | 41   | 16 | 111  |   |
|        |              |          |       |    |      |      |    |      |   |
|        |              |          |       |    |      |      |    |      |   |
|        |              |          |       |    |      |      |    |      |   |
|        |              |          |       |    |      |      |    |      |   |

## > RA2233

### RACOR HEMBRA GIRATORIA ROSCA METRICA CONO 24° SERIE LIGERA (DKOL)

DIN 2353 – ISO 8434-1 / ISO 12151-2

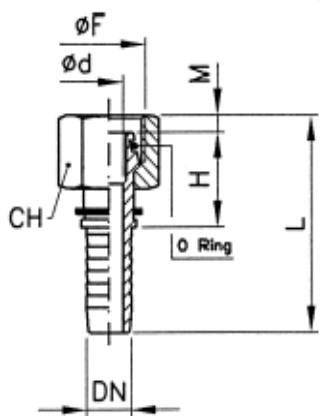

Rosca: Métrica

Cono: 24° SERIE LIGERA

Tratamiento exterior:  
galvanizado blanco trivalente

Aplicación: Fluidos hidráulicos,  
agua-glicol, agua, aire

| DN     | Referencia   | ø F      | ø DIN | CH | ø d  | H    | M   | L     | K |
|--------|--------------|----------|-------|----|------|------|-----|-------|---|
| 1/4"   | RA2233-6-4   | M-12x150 | 6L    | 19 | 3.5  | 20.7 | 0.5 | 48    |   |
| 1/4"   | RA2233-8-4   | M-14x150 | 8L    | 17 | 4    | 24.2 | -   | 51.5  |   |
| 1/4"   | RA2233-10-4  | M-16x150 | 10L   | 19 | 4    | 24.2 | -   | 51.8  |   |
| 5/16"  | RA2233-10-5  | M-16x150 | 10L   | 19 | 5.5  | 24.5 | -   | 53    |   |
| 5/16"  | RA2233-12-5  | M-18x150 | 12L   | 22 | 5.5  | 30   | -   | 58.5  |   |
| 3/8"   | RA2233-12-6  | M-18x150 | 12L   | 22 | 7    | 30   | -   | 58.5  |   |
| 1/2"   | RA2233-15-8  | M-22x150 | 15L   | 27 | 10   | 30.5 | 0.5 | 61    |   |
| 5/8"   | RA2233-18-10 | M-26x150 | 18L   | 32 | 12.5 | 30.5 | 1.5 | 65    |   |
| 3/4"   | RA2233-22-12 | M-30x200 | 22L   | 36 | 15.5 | 33   | 3   | 75    |   |
| 1"     | RA2233-28-16 | M-36x200 | 28L   | 41 | 20   | 37   | 2.5 | 92    |   |
| 1.1/4" | RA2233-35-20 | M-42x200 | 35L   | 50 | 26   | 38.5 | 2.5 | 101   |   |
| 1.1/2" | RA2233-42-24 | M-52x200 | 42L   | 60 | 32   | 41   | 2.5 | 113.5 |   |
|        |              |          |       |    |      |      |     |       |   |
|        |              |          |       |    |      |      |     |       |   |
|        |              |          |       |    |      |      |     |       |   |
|        |              |          |       |    |      |      |     |       |   |

## > RA2906

### RACOR HEMBRA GIR. CODO 90° ROSCA METRICA CONO 24° SERIE LIGERA (DKOL)

DIN 2353 – ISO 8434-1 / ISO 12151-2

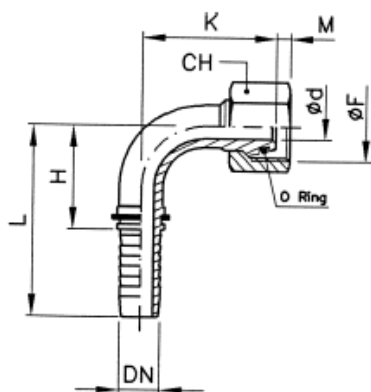

Rosca: Métrica

Cono: 24° SERIE LIGERA

Tratamiento exterior:  
galvanizado blanco trivalente

Aplicación: Fluidos hidráulicos,  
agua-glicol, agua, aire

| DN     | Referencia   | Ø F      | Ø DIN | CH | Ø d  | H    | E   | L    | K    |
|--------|--------------|----------|-------|----|------|------|-----|------|------|
| 1/4"   | RA2906-6-4   | M-12x150 | 6L    | 19 | 3.5  | 22.7 | 0.5 | 50   | 33   |
| 1/4"   | RA2906-8-4   | M-14x150 | 8L    | 17 | 4    | 24   | -   | 51.5 | 32   |
| 1/4"   | RA2906-10-4  | M-16x150 | 10L   | 19 | 4    | 24   | -   | 51.5 | 33   |
| 5/16"  | RA2906-10-5  | M-16x150 | 10L   | 19 | 5.5  | 27   | -   | 55.5 | 35   |
| 5/16"  | RA2906-12-5  | M-18x150 | 12L   | 22 | 5.5  | 27   | -   | 55.5 | 35   |
| 3/8"   | RA2906-12-6  | M-18x150 | 12L   | 22 | 7    | 31.5 | -   | 60   | 39.5 |
| 1/2"   | RA2906-15-8  | M-22x150 | 15L   | 27 | 10   | 39   | 0.5 | 69   | 44   |
| 5/8"   | RA2906-18-10 | M-26x150 | 18L   | 32 | 12.5 | 45.5 | 1.5 | 78.5 | 51.5 |
| 3/4"   | RA2906-22-12 | M-30x200 | 22L   | 36 | 15.5 | 55   | 3   | 94   | 55   |
| 1"     | RA2906-28-16 | M-36x200 | 28L   | 41 | 20   | 75.5 | 2.5 | 128  | 69   |
| 1.1/4" | RA2906-35-20 | M-42x200 | 35L   | 50 | 26   | 81   | 2.5 | 141  | 81   |
| 1.1/2" | RA2906-42-24 | M-52x200 | 42L   | 60 | 32   | 102  | 2.5 | 172  | 92   |
|        |              |          |       |    |      |      |     |      |      |
|        |              |          |       |    |      |      |     |      |      |
|        |              |          |       |    |      |      |     |      |      |
|        |              |          |       |    |      |      |     |      |      |
|        |              |          |       |    |      |      |     |      |      |

## > RA2456

### RACOR HEMBRA GIR. CODO 45° ROSCA METRICA CONO 24° SERIE LIGERA (DKOL)

DIN 2353 – ISO 8434-1 / ISO 12151-2

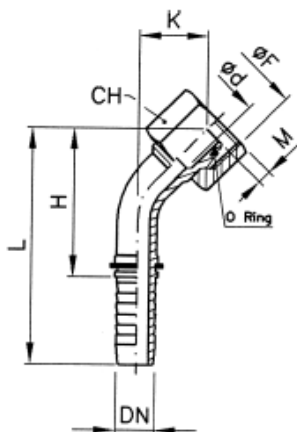

Rosca: Métrica

Cono: 24° SERIE LIGERA

Tratamiento exterior:  
galvanizado blanco trivalente

Aplicación: Fluidos hidráulicos,  
agua-glicol, agua, aire

| DN     | Referencia   | Ø F      | Ø DIN | CH | Ø d  | H    | M   | L     | K    |
|--------|--------------|----------|-------|----|------|------|-----|-------|------|
| 1/4"   | RA2456-8-4   | M-14x150 | 8L    | 17 | 4    | 41   | -   | 68.5  | 17.5 |
| 1/4"   | RA2456-10-4  | M-16x150 | 10L   | 19 | 4    | 41.5 | -   | 69    | 19   |
| 5/16"  | RA2456-10-5  | M-16x150 | 10L   | 19 | 5.5  | 47   | -   | 75.5  | 19   |
| 5/16"  | RA2456-12-5  | M-18x150 | 12L   | 22 | 5.5  | 47   | -   | 75.5  | 19   |
| 3/8"   | RA2456-12-6  | M-18x150 | 12L   | 22 | 7    | 53   | -   | 81.5  | 20.5 |
| 1/2"   | RA2456-15-8  | M-22x150 | 15L   | 27 | 10   | 63   | 0.5 | 93    | 22   |
| 5/8"   | RA2456-18-10 | M-26x150 | 18L   | 32 | 12.5 | 73.5 | 1.5 | 106.5 | 25.5 |
| 3/4"   | RA2456-22-12 | M-30x200 | 22L   | 36 | 15.5 | 87   | 3   | 126   | 27   |
| 1"     | RA2456-28-16 | M-36x200 | 28L   | 41 | 20   | 85   | 2.5 | 137.5 | 32   |
| 1.1/4" | RA2456-35-20 | M-42x200 | 35L   | 50 | 26   | 95   | 2.5 | 155   | 37   |
| 1.1/2" | RA2456-42-24 | M-52x200 | 42L   | 60 | 32   | 107  | 2.5 | 177   | 40   |
|        |              |          |       |    |      |      |     |       |      |
|        |              |          |       |    |      |      |     |       |      |
|        |              |          |       |    |      |      |     |       |      |
|        |              |          |       |    |      |      |     |       |      |
|        |              |          |       |    |      |      |     |       |      |

## > RA2143

### RACOR MACHO FIJO ROSCA METRICA CONO 24° SERIE PESADA (DKOS)

DIN 2353 – ISO 8434-1 / ISO 12151-2

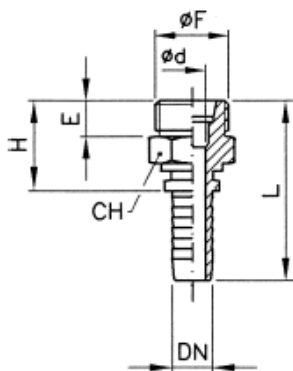

Rosca: Métrica

Cono: 24° SERIE PESADA

Tratamiento exterior:  
galvanizado blanco trivalente

Aplicación: Fluidos hidráulicos,  
agua-glicol, agua, aire

| DN     | Referencia   | Ø F      | Ø DIN | CH | Ø d  | H    | E  | L   | K |
|--------|--------------|----------|-------|----|------|------|----|-----|---|
| 1/4"   | RA2143-8-4   | M-16x150 | 8S    | 17 | 4    | 25.7 | 12 | 53  |   |
| 1/4"   | RA2143-10-4  | M-18x150 | 10S   | 19 | 4    | 26.7 | 12 | 54  |   |
| 5/16"  | RA2143-12-5  | M-20x150 | 12S   | 22 | 5.5  | 28.5 | 12 | 57  |   |
| 3/8"   | RA2143-12-6  | M-20x150 | 12S   | 22 | 7    | 28.5 | 12 | 57  |   |
| 3/8"   | RA2143-14-6  | M-22x150 | 14S   | 24 | 7    | 30.5 | 14 | 59  |   |
| 1/2"   | RA2143-14-8  | M-22x150 | 14S   | 24 | 10   | 31   | 14 | 61  |   |
| 1/2"   | RA2143-16-8  | M-24x150 | 16S   | 27 | 10   | 31   | 14 | 61  |   |
| 5/8"   | RA2143-20-10 | M-30x200 | 20S   | 32 | 12.5 | 35   | 16 | 68  |   |
| 3/4"   | RA2143-20-12 | M-30x200 | 20S   | 32 | 15.5 | 36   | 16 | 75  |   |
| 3/4"   | RA2143-25-12 | M-36x200 | 25S   | 41 | 15.5 | 40   | 18 | 79  |   |
| 1"     | RA2143-25-16 | M-36x200 | 25S   | 41 | 20   | 40.5 | 18 | 93  |   |
| 1"     | RA2143-30-16 | M-42x200 | 30S   | 46 | 20   | 43.5 | 20 | 96  |   |
| 1.1/4" | RA2143-38-20 | M-52x200 | 38S   | 55 | 26   | 49   | 22 | 109 |   |
|        |              |          |       |    |      |      |    |     |   |
|        |              |          |       |    |      |      |    |     |   |
|        |              |          |       |    |      |      |    |     |   |
|        |              |          |       |    |      |      |    |     |   |

## > RA2223

### RACOR HEMBRA GIRATORIA ROSCA METRICA CONO 24° SERIE PESADA (DKOS)

DIN 2353 – ISO 8434-1 / ISO 12151-2

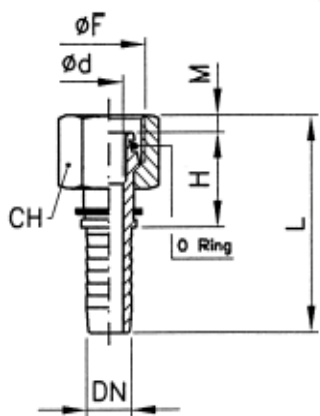

Rosca: Métrica

Cono: 24° SERIE PESADA

Tratamiento exterior:  
galvanizado blanco trivalente

Aplicación: Fluidos hidráulicos,  
agua-glicol, agua, aire

| DN     | Referencia   | Ø F      | Ø DIN | CH | Ø d  | H    | M   | L     | K |
|--------|--------------|----------|-------|----|------|------|-----|-------|---|
| 1/4"   | RA2223-8-4   | M-16x150 | 8S    | 17 | 4    | 24.2 | 2   | 53.5  |   |
| 1/4"   | RA2223-10-4  | M-18x150 | 10S   | 19 | 4    | 24.5 | 1   | 52.8  |   |
| 5/16"  | RA2223-12-5  | M-20x150 | 12S   | 22 | 5.5  | 30   | 1   | 59.5  |   |
| 3/8"   | RA2223-12-6  | M-20x150 | 12S   | 22 | 7    | 30   | 1   | 59.5  |   |
| 3/8"   | RA2223-14-6  | M-22x150 | 14S   | 24 | 7    | 30.5 | 1.5 | 60.5  |   |
| 1/2"   | RA2223-14-8  | M-22x150 | 14S   | 24 | 10   | 30.5 | 1.5 | 62    |   |
| 1/2"   | RA2223-16-8  | M-24x150 | 16S   | 27 | 10   | 31.5 | 2   | 63.5  |   |
| 5/8"   | RA2223-20-10 | M-30x200 | 20S   | 32 | 12.5 | 36.5 | 1   | 70.5  |   |
| 3/4"   | RA2223-20-12 | M-30x200 | 20S   | 32 | 15.5 | 36.5 | 1   | 76.5  |   |
| 3/4"   | RA2223-25-12 | M-36x200 | 25S   | 41 | 15.5 | 37   | 5   | 81    |   |
| 1"     | RA2223-25-16 | M-36x200 | 25S   | 41 | 20   | 37   | 3   | 92.5  |   |
| 1"     | RA2223-30-16 | M-42x200 | 30S   | 46 | 20   | 41.5 | 6.5 | 100.5 |   |
| 1.1/4" | RA2223-38-20 | M-52x200 | 38S   | 55 | 26   | 46   | 8.5 | 114.5 |   |
|        |              |          |       |    |      |      |     |       |   |
|        |              |          |       |    |      |      |     |       |   |
|        |              |          |       |    |      |      |     |       |   |
|        |              |          |       |    |      |      |     |       |   |



## > RA2902

### RACOR HEMBRA GIR. CODO 90° ROSCA METRICA CONO 24° SERIE PESADA (DKOS)

DIN 2353 – ISO 8434-1 / ISO 12151-2

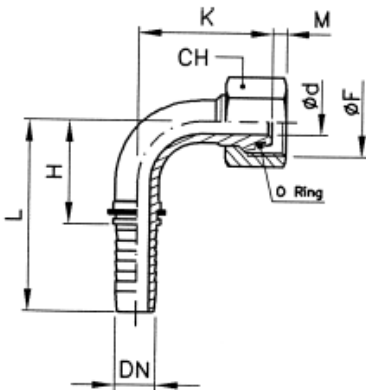

Rosca: Métrica

Cono: 24° SERIE PESADA

Tratamiento exterior:  
galvanizado blanco trivalente

Aplicación: Fluidos hidráulicos,  
agua-glicol, agua, aire

| DN     | Referencia   | Ø F      | Ø DIN | CH | Ø d  | H    | M   | L    | K    |
|--------|--------------|----------|-------|----|------|------|-----|------|------|
| 1/4"   | RA2902-8-4   | M-16x150 | 8S    | 17 | 4    | 24   | 2   | 51.5 | 32   |
| 1/4"   | RA2902-10-4  | M-18x150 | 10S   | 19 | 4    | 24   | 1   | 51.5 | 33   |
| 5/16"  | RA2902-12-5  | M-20x150 | 12S   | 22 | 5.5  | 27   | 1   | 55.5 | 35   |
| 3/8"   | RA2902-12-6  | M-20x150 | 12S   | 22 | 7    | 31.5 | 1   | 60   | 39.5 |
| 3/8"   | RA2902-14-6  | M-22x150 | 14S   | 24 | 7    | 31   | 1.5 | 59.5 | 42.5 |
| 1/2"   | RA2902-14-8  | M-22x150 | 14S   | 24 | 10   | 39   | 1.5 | 69   | 47   |
| 1/2"   | RA2902-16-8  | M-24x150 | 16S   | 27 | 10   | 39   | 2   | 69   | 47   |
| 5/8"   | RA2902-20-10 | M-30x200 | 20S   | 32 | 12.5 | 45.5 | 1   | 78.5 | 57.5 |
| 3/4"   | RA2902-20-12 | M-30x200 | 20S   | 32 | 15.5 | 55   | 1   | 94   | 62   |
| 3/4"   | RA2902-25-12 | M-36x200 | 25S   | 41 | 15.5 | 55   | 5   | 94   | 62   |
| 1"     | RA2902-25-16 | M-36x200 | 25S   | 41 | 20   | 75.5 | 3   | 128  | 73   |
| 1"     | RA2902-30-16 | M-42x200 | 30S   | 46 | 20   | 75.5 | 6.5 | 128  | 73   |
| 1.1/4" | RA2902-38-20 | M-52x200 | 38S   | 55 | 26   | 81   | 8.5 | 141  | 83.5 |
|        |              |          |       |    |      |      |     |      |      |
|        |              |          |       |    |      |      |     |      |      |
|        |              |          |       |    |      |      |     |      |      |
|        |              |          |       |    |      |      |     |      |      |

## > RA2452

### RACOR HEMBRA GIR. CODO 45° ROSCA METRICA CONO 24° SERIE PESADA (DKOS)

DIN 2353 – ISO 8434-1 / ISO 12151-2

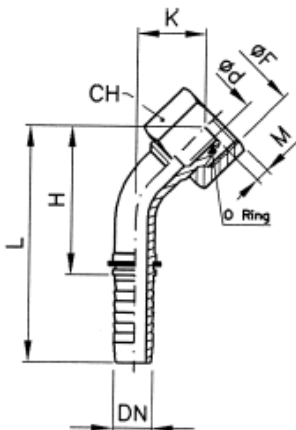

Rosca: Métrica

Cono: 24° SERIE PESADA

Tratamiento exterior:  
galvanizado blanco trivalente

Aplicación: Fluidos hidráulicos,  
agua-glicol, agua, aire

| DN     | Referencia   | Ø F      | Ø DIN | CH | Ø d  | H    | M   | L     | K    |
|--------|--------------|----------|-------|----|------|------|-----|-------|------|
| 1/4"   | RA2452-8-4   | M-16x150 | 8S    | 17 | 4    | 41   | 2   | 68.5  | 17.5 |
| 1/4"   | RA2452-10-4  | M-18x150 | 10S   | 19 | 4    | 41.5 | 1   | 69    | 18   |
| 5/16"  | RA2452-12-5  | M-20x150 | 12S   | 22 | 5.5  | 47   | 1   | 75.5  | 19   |
| 3/8"   | RA2452-12-6  | M-20x150 | 12S   | 22 | 7    | 53   | 1   | 81.5  | 20.5 |
| 3/8"   | RA2452-14-6  | M-22x150 | 14S   | 24 | 7    | 54.5 | 1.5 | 83    | 22.5 |
| 1/2"   | RA2452-14-8  | M-22x150 | 14S   | 24 | 10   | 65   | 1.5 | 95    | 24   |
| 1/2"   | RA2452-16-8  | M-24x150 | 16S   | 27 | 10   | 65   | 2   | 95    | 24   |
| 5/8"   | RA2452-20-10 | M-30x200 | 20S   | 32 | 12.5 | 77.5 | 1   | 110.5 | 29.5 |
| 3/4"   | RA2452-20-12 | M-30x200 | 20S   | 32 | 15.5 | 68   | 1   | 107   | 31   |
| 3/4"   | RA2452-25-12 | M-36x200 | 25S   | 41 | 15.5 | 68   | 5   | 107   | 31   |
| 1"     | RA2452-25-16 | M-36x200 | 25S   | 41 | 20   | 88   | 3   | 140.5 | 35   |
| 1"     | RA2452-30-16 | M-42x200 | 30S   | 46 | 20   | 88   | 6.5 | 140.5 | 35   |
| 1.1/4" | RA2452-38-20 | M-52x200 | 38S   | 55 | 26   | 97   | 8.5 | 157   | 38.5 |
|        |              |          |       |    |      |      |     |       |      |
|        |              |          |       |    |      |      |     |       |      |
|        |              |          |       |    |      |      |     |       |      |
|        |              |          |       |    |      |      |     |       |      |



## > RA2TR3

### RACOR ESPIGA LISA TUBO METRICO SERIE LIGERA (DKOL)

ISO 8434-1

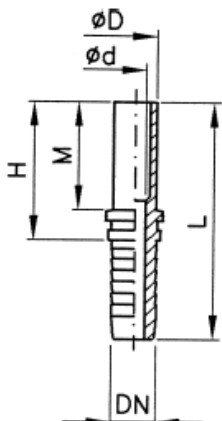

Rosca: Métrica

Cono: SERIE LIGERA

Tratamiento exterior:  
galvanizado blanco trivalente

Aplicación: Fluidos hidráulicos,  
agua-glicol, agua, aire

| DN     | Referencia   | DIN | ø D | ø d  | H    | M  | L     |  |  |
|--------|--------------|-----|-----|------|------|----|-------|--|--|
| 1/4"   | RA2TR3-6-4   | 6L  | 6   | 4    | 28.7 | 22 | 56    |  |  |
| 1/4"   | RA2TR3-8-4   | 8L  | 8   | 4    | 28.7 | 22 | 56    |  |  |
| 5/16"  | RA2TR3-10-5  | 10L | 10  | 5.5  | 31   | 23 | 59.5  |  |  |
| 3/8"   | RA2TR3-10-6  | 10L | 10  | 7    | 31   | 23 | 59.5  |  |  |
| 3/8"   | RA2TR3-12-6  | 12L | 12  | 7    | 31   | 23 | 59.5  |  |  |
| 1/2"   | RA2TR3-15-8  | 15L | 15  | 10   | 34   | 25 | 64    |  |  |
| 3/4"   | RA2TR3-18-10 | 18L | 18  | 12.5 | 35   | 26 | 68    |  |  |
| 3/4"   | RA2TR3-22-12 | 22L | 22  | 15.5 | 38.5 | 28 | 77.5  |  |  |
| 1"     | RA2TR3-28-16 | 28L | 28  | 20   | 41   | 30 | 93.5  |  |  |
| 1.1/4" | RA2TR3-35-20 | 35L | 35  | 26   | 47.5 | 36 | 107.5 |  |  |
| 1.1/2" | RA2TR3-42-24 | 42L | 42  | 32   | 51.5 | 40 | 121.5 |  |  |
|        |              |     |     |      |      |    |       |  |  |
|        |              |     |     |      |      |    |       |  |  |
|        |              |     |     |      |      |    |       |  |  |
|        |              |     |     |      |      |    |       |  |  |
|        |              |     |     |      |      |    |       |  |  |

## > RA2TR4

### RACOR ESPIGA LISA TUBO METRICO SERIE PESADA (DKOS)

ISO 8434-1

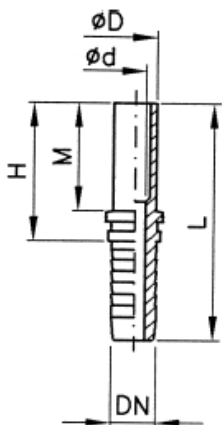

Rosca: Métrica

Cono: SERIE PESADA

Tratamiento exterior:  
galvanizado blanco trivalente

Aplicación: Fluidos hidráulicos,  
agua-glicol, agua, aire

| DN     | Referencia   | DIN | ø D | ø d  | H    | M  | L     |  |  |
|--------|--------------|-----|-----|------|------|----|-------|--|--|
| 1/4"   | RA2TR4-8-4   | 8S  | 8   | 4    | 26.7 | 22 | 56    |  |  |
| 1/4"   | RA2TR4-10-4  | 10S | 10  | 4    | 32.7 | 26 | 60    |  |  |
| 5/16"  | RA2TR4-12-5  | 12S | 12  | 5.5  | 34   | 26 | 62.5  |  |  |
| 3/8"   | RA2TR4-14-6  | 14S | 14  | 7    | 37   | 29 | 65.5  |  |  |
| 1/2"   | RA2TR4-14-8  | 14S | 14  | 10   | 38   | 29 | 68    |  |  |
| 1/2"   | RA2TR4-16-8  | 16S | 16  | 10   | 39   | 30 | 69    |  |  |
| 5/8"   | RA2TR4-20-10 | 20S | 20  | 12.5 | 45   | 36 | 78    |  |  |
| 3/4"   | RA2TR4-20-12 | 20S | 20  | 15.5 | 46.5 | 36 | 85.5  |  |  |
| 3/4"   | RA2TR4-25-12 | 25S | 25  | 15.5 | 50.5 | 40 | 89.5  |  |  |
| 1"     | RA2TR4-25-16 | 25S | 25  | 20   | 51   | 40 | 103.5 |  |  |
| 1"     | RA2TR4-30-16 | 30S | 30  | 20   | 55   | 44 | 107.5 |  |  |
| 1.1/4" | RA2TR4-38-20 | 38S | 38  | 26   | 61.5 | 50 | 121.5 |  |  |
|        |              |     |     |      |      |    |       |  |  |
|        |              |     |     |      |      |    |       |  |  |
|        |              |     |     |      |      |    |       |  |  |
|        |              |     |     |      |      |    |       |  |  |
|        |              |     |     |      |      |    |       |  |  |

## > RA290TR3

### RACOR ESPIGA LISA CODO 90° TUBO METRICO SERIE LIGERA (DKOL)

ISO 8434-1

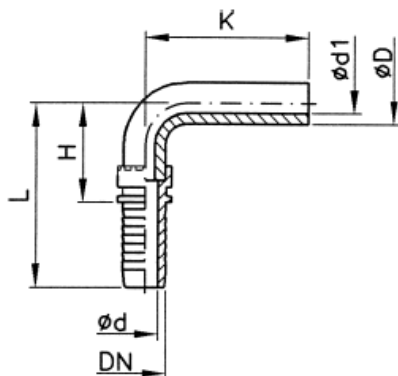

Rosca: Métrica

Cono: SERIE LIGERA

Tratamiento exterior:  
galvanizado blanco trivalente

Aplicación: Fluidos hidráulicos,  
agua-glicol, agua, aire

| DN     | Referencia     | DIN | Ø D | Ø d  | Ø d1 | K    | H    | L     |
|--------|----------------|-----|-----|------|------|------|------|-------|
| 1/4"   | RA290TR3-6-4   | 6L  | 6   | 4    | 4    | 36   | 26   | 53.3  |
| 1/4"   | RA290TR3-8-4   | 8L  | 8   | 4    | 5    | 39   | 28   | 55.3  |
| 5/16"  | RA290TR3-10-5  | 10L | 10  | 5.5  | 7    | 42   | 31.5 | 60    |
| 3/8"   | RA290TR3-10-6  | 10L | 10  | 7    | 7    | 42   | 31.5 | 60    |
| 3/8"   | RA290TR3-12-6  | 12L | 12  | 7    | 8    | 45   | 35   | 63.5  |
| 1/2"   | RA290TR3-15-8  | 15L | 15  | 10   | 11   | 52.5 | 39   | 69    |
| 3/4"   | RA290TR3-18-10 | 18L | 18  | 12.5 | 15   | 58   | 45   | 78    |
| 3/4"   | RA290TR3-22-12 | 22L | 22  | 15.5 | 17   | 65   | 49   | 88    |
| 1"     | RA290TR3-28-16 | 28L | 28  | 20   | 23   | 75.5 | 58   | 110.5 |
| 1.1/4" | RA290TR3-35-20 | 35L | 35  | 26   | 29   | 95   | 74   | 134   |
| 1.1/2" | RA290TR3-42-24 | 42L | 42  | 32   | 36   | 118  | 93   | 163   |
|        |                |     |     |      |      |      |      |       |
|        |                |     |     |      |      |      |      |       |
|        |                |     |     |      |      |      |      |       |
|        |                |     |     |      |      |      |      |       |
|        |                |     |     |      |      |      |      |       |

## > RA290TR4

### RACOR ESPIGA LISA CODO 90° TUBO METRICO SERIE PESADA (DKOS)

ISO 8434-1

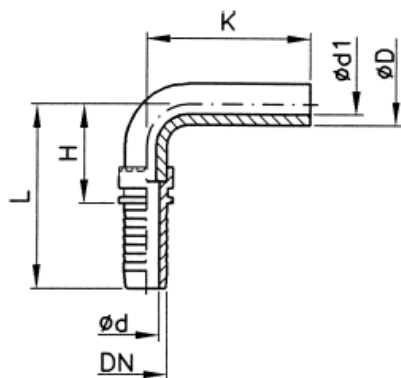

Rosca: Métrica

Cono: SERIE PESADA

Tratamiento exterior:  
galvanizado blanco trivalente

Aplicación: Fluidos hidráulicos,  
agua-glicol, agua, aire

| DN     | Referencia     | DIN | Ø D | Ø d  | Ø d1 | K    | H    | L     |
|--------|----------------|-----|-----|------|------|------|------|-------|
| 1/4"   | RA290TR4-8-4   | 8S  | 8   | 4    | 5    | 39   | 28   | 55.3  |
| 1/4"   | RA290TR4-10-4  | 10S | 10  | 4    | 7    | 42   | 31   | 58.3  |
| 5/16"  | RA290TR4-12-5  | 12S | 12  | 5.5  | 8    | 45   | 35   | 63.5  |
| 3/8"   | RA290TR4-14-6  | 14S | 14  | 7    | 10   | 52   | 38   | 66.5  |
| 1/2"   | RA290TR4-14-8  | 14S | 14  | 10   | 10   | 52   | 39   | 69    |
| 1/2"   | RA290TR4-16-8  | 16S | 16  | 10   | 12   | 55   | 42   | 72    |
| 5/8"   | RA290TR4-20-10 | 20S | 20  | 12.5 | 15   | 55   | 48   | 81    |
| 3/4"   | RA290TR4-20-12 | 20S | 20  | 15.5 | 15   | 65   | 49   | 88    |
| 3/4"   | RA290TR4-25-12 | 25S | 25  | 15.5 | 20   | 75.5 | 57.5 | 96.5  |
| 1"     | RA290TR4-25-16 | 25S | 25  | 20   | 20   | 75.5 | 58   | 110.5 |
| 1"     | RA290TR4-30-16 | 30S | 30  | 20   | 24   | 87   | 67   | 119.5 |
| 1.1/4" | RA290TR4-38-20 | 38S | 38  | 26   | 30   | 105  | 83   | 143   |
|        |                |     |     |      |      |      |      |       |
|        |                |     |     |      |      |      |      |       |
|        |                |     |     |      |      |      |      |       |
|        |                |     |     |      |      |      |      |       |
|        |                |     |     |      |      |      |      |       |

## > RA245TR3

### RACOR ESPIGA LISA CODO 45° TUBO METRICO SERIE LIGERA (DKOL)

ISO 8434-1

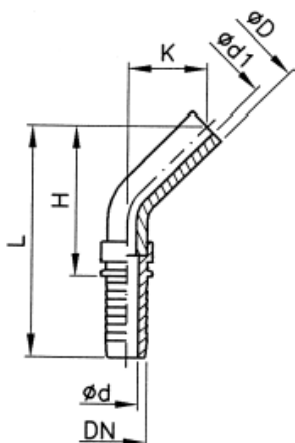

Rosca: Métrica

Cono: SERIE LIGERA

Tratamiento exterior:  
galvanizado blanco trivalente

Aplicación: Fluidos hidráulicos,  
agua-glicol, agua, aire

| DN     | Referencia     | DIN | ø D | ø d  | ø d1 | K    | H     | L     |
|--------|----------------|-----|-----|------|------|------|-------|-------|
| 1/4"   | RA245TR3-6-4   | 6L  | 6   | 4    | 4    | 21   | 44    | 71.3  |
| 1/4"   | RA245TR3-8-4   | 8L  | 8   | 4    | 5    | 22   | 44    | 71.3  |
| 5/16"  | RA245TR3-10-5  | 10L | 10  | 5.5  | 7    | 23   | 45.5  | 73.5  |
| 3/8"   | RA245TR3-10-6  | 10L | 10  | 7    | 7    | 23   | 45.5  | 76.5  |
| 3/8"   | RA245TR3-12-6  | 12L | 12  | 7    | 8    | 23.5 | 49    | 77.5  |
| 1/2"   | RA245TR3-15-8  | 15L | 15  | 10   | 11   | 27.5 | 54.5  | 84.5  |
| 3/4"   | RA245TR3-18-10 | 18L | 18  | 12.5 | 15   | 28.5 | 61    | 94    |
| 3/4"   | RA245TR3-22-12 | 22L | 22  | 15.5 | 17   | 32.5 | 67    | 106   |
| 1"     | RA245TR3-28-16 | 28L | 28  | 20   | 23   | 40.5 | 87.5  | 140   |
| 1.1/4" | RA245TR3-35-20 | 35L | 35  | 26   | 29   | 46   | 96    | 156   |
| 1.1/2" | RA245TR3-42-24 | 42L | 42  | 32   | 36   | 54   | 113.5 | 183.5 |
|        |                |     |     |      |      |      |       |       |
|        |                |     |     |      |      |      |       |       |
|        |                |     |     |      |      |      |       |       |
|        |                |     |     |      |      |      |       |       |
|        |                |     |     |      |      |      |       |       |

## > RA245TR4

### RACOR ESPIGA LISA CODO 45° TUBO METRICO SERIE PESADA (DKOS)

ISO 8434-1

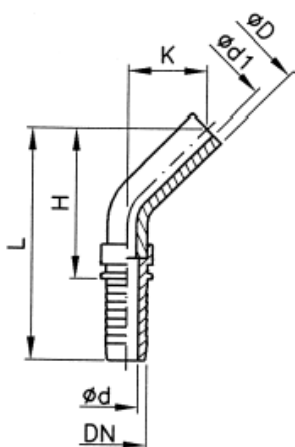

Rosca: Métrica

Cono: SERIE PESADA

Tratamiento exterior:  
galvanizado blanco trivalente

Aplicación: Fluidos hidráulicos,  
agua-glicol, agua, aire

| DN     | Referencia     | DIN | ø D | ø d  | ø d1 | K    | H    | L     |
|--------|----------------|-----|-----|------|------|------|------|-------|
| 1/4"   | RA245TR4-8-4   | 8S  | 8   | 4    | 5    | 22   | 44   | 71.3  |
| 1/4"   | RA245TR4-10-4  | 10S | 10  | 4    | 7    | 23   | 45.5 | 72.8  |
| 5/16"  | RA245TR4-12-5  | 12S | 12  | 5.5  | 8    | 23.5 | 49   | 77.5  |
| 3/8"   | RA245TR4-14-6  | 14S | 14  | 7    | 10   | 27   | 54   | 82.5  |
| 1/2"   | RA245TR4-14-8  | 14S | 14  | 10   | 10   | 27.5 | 58   | 88    |
| 1/2"   | RA245TR4-16-8  | 16S | 16  | 10   | 12   | 27.5 | 59   | 89    |
| 5/8"   | RA245TR4-20-10 | 20S | 20  | 12.5 | 15   | 32   | 66   | 99    |
| 3/4"   | RA245TR4-20-12 | 20S | 20  | 15.5 | 15   | 32   | 66   | 105   |
| 3/4"   | RA245TR4-25-12 | 25S | 25  | 15.5 | 20   | 36   | 75.5 | 114.5 |
| 1"     | RA245TR4-25-16 | 25S | 25  | 20   | 20   | 36   | 76   | 128.5 |
| 1"     | RA245TR4-30-16 | 30S | 30  | 20   | 24   | 40.5 | 87.5 | 140   |
| 1.1/4" | RA245TR4-38-20 | 38S | 38  | 26   | 30   | 47.5 | 104  | 164   |
|        |                |     |     |      |      |      |      |       |
|        |                |     |     |      |      |      |      |       |
|        |                |     |     |      |      |      |      |       |
|        |                |     |     |      |      |      |      |       |
|        |                |     |     |      |      |      |      |       |

## > RA2PS1

### RACOR PLATINA RECTA SAE 3000 PSI

SAE J518 - ISO 6162-1 / ISO 12151-3

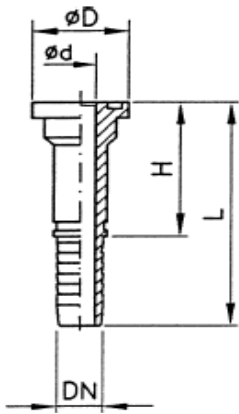

Conexión: SAE 3000

Serie: SERIE LIGERA

Tratamiento exterior:  
galvanizado blanco trivalente

Aplicación: Fluidos hidráulicos,  
agua-glicol, agua, aire

| DN     | Referencia   | DN Brida | Ø D  | Ø d  | H    | L     |  |  |
|--------|--------------|----------|------|------|------|-------|--|--|
| 1/2"   | RA2PS1-8     | 1/2"     | 30.2 | 10   | 51   | 81    |  |  |
| 1/2"   | RA2PS1-12-8  | 3/4"     | 38.1 | 10   | 57.5 | 87.5  |  |  |
| 3/4"   | RA2PS1-12    | 3/4"     | 38.1 | 15.5 | 58   | 97    |  |  |
| 3/4"   | RA2PS1-16-12 | 1"       | 44.5 | 15.5 | 58   | 97    |  |  |
| 1"     | RA2PS1-16    | 1"       | 44.5 | 20   | 64.5 | 114   |  |  |
| 1"     | RA2PS1-20-16 | 1.1/4"   | 50.8 | 20   | 70.5 | 123   |  |  |
| 1.1/4" | RA2PS1-20    | 1.1/4"   | 50.8 | 26   | 70.5 | 130.5 |  |  |
| 1.1/4" | RA2PS1-24-20 | 1.1/2"   | 60.3 | 26   | 72.5 | 132.5 |  |  |
| 1.1/2" | RA2PS1-24    | 1.1/2"   | 60.3 | 32   | 75.5 | 145.5 |  |  |
| 1.1/2" | RA2PS1-32-24 | 2"       | 71.4 | 32   | 75.5 | 145.5 |  |  |
| 2"     | RA2PS1-32    | 2"       | 71.4 | 44   | 79   | 153.5 |  |  |
|        |              |          |      |      |      |       |  |  |
|        |              |          |      |      |      |       |  |  |
|        |              |          |      |      |      |       |  |  |
|        |              |          |      |      |      |       |  |  |
|        |              |          |      |      |      |       |  |  |
|        |              |          |      |      |      |       |  |  |
|        |              |          |      |      |      |       |  |  |
|        |              |          |      |      |      |       |  |  |
|        |              |          |      |      |      |       |  |  |
|        |              |          |      |      |      |       |  |  |

## > RA2PS2

### RACOR PLATINA RECTA SAE 6000 PSI

SAE J518 - ISO 6162-2 / ISO 12151-3

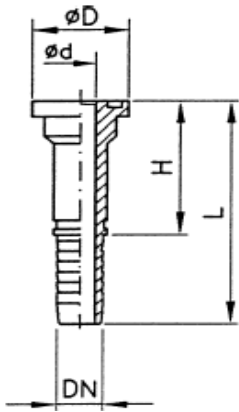

Conexión: SAE 6000

Serie: SERIE PESADA

Tratamiento exterior:  
galvanizado blanco trivalente

Aplicación: Fluidos hidráulicos,  
agua-glicol, agua, aire

| DN     | Referencia   | DN Brida | Ø D  | Ø d  | H    | L     |  |  |
|--------|--------------|----------|------|------|------|-------|--|--|
| 1/2"   | RA2PS2-8     | 1/2"     | 31.7 | 10   | 52   | 82    |  |  |
| 1/2"   | RA2PS2-12-8  | 3/4"     | 41.3 | 10   | 68.5 | 98.5  |  |  |
| 3/4"   | RA2PS2-12    | 3/4"     | 41.3 | 15.5 | 69   | 108   |  |  |
| 3/4"   | RA2PS2-16-12 | 1"       | 47.6 | 15.5 | 81   | 120   |  |  |
| 1"     | RA2PS2-16    | 1"       | 47.6 | 20   | 82   | 134.5 |  |  |
| 1"     | RA2PS2-20-16 | 1.1/4"   | 54   | 20   | 89   | 141.5 |  |  |
| 1.1/4" | RA2PS2-20    | 1.1/4"   | 54   | 26   | 84.5 | 144.5 |  |  |
| 1.1/4" | RA2PS2-24-20 | 1.1/2"   | 63.5 | 26   | 90.5 | 150.5 |  |  |
| 1.1/2" | RA2PS2-24    | 1.1/2"   | 63.5 | 32   | 92.5 | 162.5 |  |  |
| 2"     | RA2PS2-32    | 2"       | 79.4 | 44   | 107  | 181.5 |  |  |
|        |              |          |      |      |      |       |  |  |
|        |              |          |      |      |      |       |  |  |
|        |              |          |      |      |      |       |  |  |
|        |              |          |      |      |      |       |  |  |
|        |              |          |      |      |      |       |  |  |
|        |              |          |      |      |      |       |  |  |
|        |              |          |      |      |      |       |  |  |
|        |              |          |      |      |      |       |  |  |
|        |              |          |      |      |      |       |  |  |
|        |              |          |      |      |      |       |  |  |
|        |              |          |      |      |      |       |  |  |
|        |              |          |      |      |      |       |  |  |



## > RA245PS

### RACOR PLATINA CODO 45° SAE 3000 PSI

SAE J518 - ISO 6162-1 / ISO 12151-3

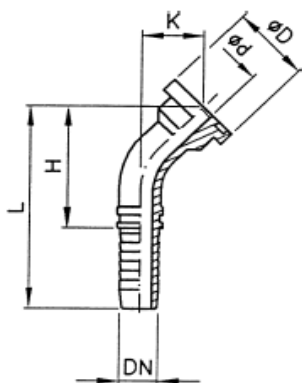

Conexión: SAE 3000

Serie: SERIE LIGERA

Tratamiento exterior:  
galvanizado blanco trivalente

Aplicación: Fluidos hidráulicos,  
agua-glicol, agua, aire

| DN     | Referencia    | DN Brida | Ø D  | Ø d  | H    | K    | L     |
|--------|---------------|----------|------|------|------|------|-------|
| 1/2"   | RA245PS-8     | 1/2"     | 30.2 | 10   | 58.5 | 19.5 | 88.5  |
| 1/2"   | RA245PS-12-8  | 3/4"     | 38.1 | 10   | 59.5 | 22   | 89.5  |
| 3/4"   | RA245PS-12    | 3/4"     | 38.1 | 15.5 | 68.5 | 24   | 107.5 |
| 3/4"   | RA245PS-16-12 | 1"       | 44.5 | 15.5 | 68.5 | 25.5 | 107.5 |
| 1"     | RA245PS-16    | 1"       | 44.5 | 20   | 82   | 27.5 | 134.5 |
| 1"     | RA245PS-20-16 | 1.1/4"   | 50.8 | 20   | 82   | 28.5 | 134.5 |
| 1.1/4" | RA245PS-20    | 1.1/4"   | 50.8 | 26   | 95.5 | 32   | 155.5 |
| 1.1/4" | RA245PS-24-20 | 1.1/2"   | 60.3 | 26   | 97   | 33.5 | 157   |
| 1.1/2" | RA245PS-24    | 1.1/2"   | 60.3 | 32   | 111  | 37   | 181   |
| 1.1/2" | RA245PS-32-24 | 2"       | 71.4 | 32   | 111  | 38   | 181   |
| 2"     | RA245PS-32    | 2"       | 71.4 | 44   | 124  | 41.5 | 198.5 |
|        |               |          |      |      |      |      |       |
|        |               |          |      |      |      |      |       |
|        |               |          |      |      |      |      |       |
|        |               |          |      |      |      |      |       |
|        |               |          |      |      |      |      |       |

## > RA245BS

### RACOR PLATINA CODO 45° SAE 6000 PSI

SAE J518 - ISO 6162-2 / ISO 12151-3

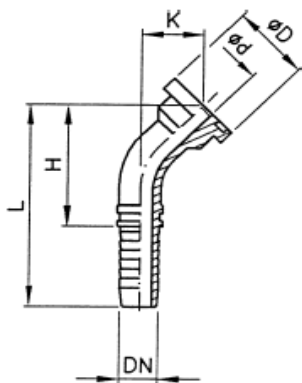

Conexión: SAE 6000

Serie: SERIE PESADA

Tratamiento exterior:  
galvanizado blanco trivalente

Aplicación: Fluidos hidráulicos,  
agua-glicol, agua, aire

| DN     | Referencia    | DN Brida | Ø D  | Ø d  | H     | K    | L     |
|--------|---------------|----------|------|------|-------|------|-------|
| 1/2"   | RA245BS-8     | 1/2"     | 31.7 | 10   | 62    | 22   | 92    |
| 1/2"   | RA245BS-12-8  | 3/4"     | 41.3 | 10   | 68    | 27.5 | 98    |
| 3/4"   | RA245BS-12    | 3/4"     | 41.3 | 15.5 | 74    | 29.5 | 113   |
| 3/4"   | RA245BS-16-12 | 1"       | 47.6 | 15.5 | 79    | 33.5 | 118   |
| 1"     | RA245BS-16    | 1"       | 47.6 | 20   | 84    | 34   | 136.5 |
| 1"     | RA245BS-20-16 | 1.1/4"   | 54   | 20   | 89    | 39   | 141.5 |
| 1.1/4" | RA245BS-20    | 1.1/4"   | 54   | 26   | 102   | 43.5 | 162   |
| 1.1/4" | RA245BS-24-20 | 1.1/2"   | 63.5 | 26   | 108   | 49   | 168   |
| 1.1/2" | RA245BS-24    | 1.1/2"   | 63.5 | 32   | 121   | 50   | 191   |
| 2"     | RA245BS-32    | 2"       | 79.4 | 44   | 147.5 | 60.5 | 222   |
|        |               |          |      |      |       |      |       |
|        |               |          |      |      |       |      |       |
|        |               |          |      |      |       |      |       |
|        |               |          |      |      |       |      |       |
|        |               |          |      |      |       |      |       |

## > RA290PS

### RACOR PLATINA CODO 90° SAE 3000 PSI

SAE J518 - ISO 6162-1 / ISO 12151-3

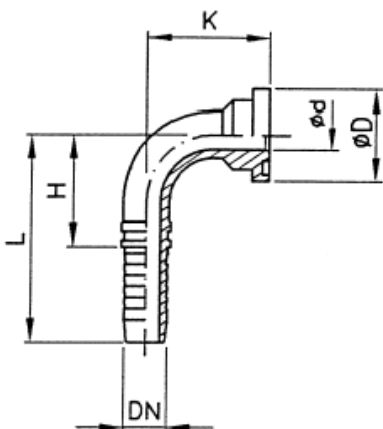

Conexión: SAE 3000

Serie: SERIE LIGERA

Tratamiento exterior:  
galvanizado blanco trivalente

Aplicación: Fluidos hidráulicos,  
agua-glicol, agua, aire

| DN     | Referencia    | DN Brida | Ø D  | Ø d  | H    | K    | L     |
|--------|---------------|----------|------|------|------|------|-------|
| 1/2"   | RA290PS-8     | 1/2"     | 30.2 | 10   | 54.5 | 40   | 84.5  |
| 1/2"   | RA290PS-12-8  | 3/4"     | 38.1 | 10   | 54.5 | 44   | 84.5  |
| 3/4"   | RA290PS-12    | 3/4"     | 38.1 | 15.5 | 64.5 | 52   | 103.5 |
| 3/4"   | RA290PS-16-12 | 1"       | 44.5 | 15.5 | 64.5 | 54   | 103.5 |
| 1"     | RA290PS-16    | 1"       | 44.5 | 20   | 77.5 | 62   | 130   |
| 1"     | RA290PS-20-16 | 1.1/4"   | 50.8 | 20   | 77.5 | 63.5 | 130   |
| 1.1/4" | RA290PS-20    | 1.1/4"   | 50.8 | 26   | 93.5 | 75   | 153.5 |
| 1.1/4" | RA290PS-24-20 | 1.1/2"   | 60.3 | 26   | 93.5 | 77   | 153.5 |
| 1.1/2" | RA290PS-24    | 1.1/2"   | 60.3 | 32   | 111  | 89   | 181   |
| 1.1/2" | RA290PS-32-24 | 2"       | 71.4 | 32   | 111  | 89   | 181   |
| 2"     | RA290PS-32    | 2"       | 71.4 | 44   | 129  | 112  | 203.5 |
|        |               |          |      |      |      |      |       |
|        |               |          |      |      |      |      |       |
|        |               |          |      |      |      |      |       |
|        |               |          |      |      |      |      |       |
|        |               |          |      |      |      |      |       |

## > RA290BS

### RACOR PLATINA CODO 90° SAE 6000 PSI

SAE J518 - ISO 6162-2 / ISO 12151-3

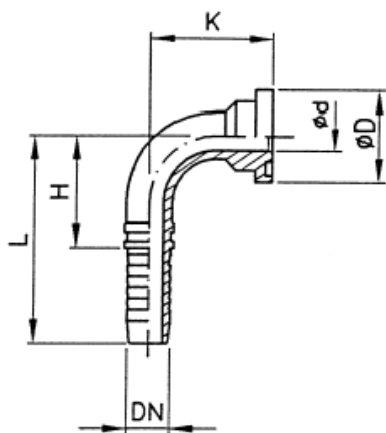

Conexión: SAE 6000

Serie: SERIE PESADA

Tratamiento exterior:  
galvanizado blanco trivalente

Aplicación: Fluidos hidráulicos,  
agua-glicol, agua, aire

| DN     | Referencia    | DN Brida | Ø D  | Ø d  | H    | K     | L     |
|--------|---------------|----------|------|------|------|-------|-------|
| 1/2"   | RA290BS-8     | 1/2"     | 31.7 | 10   | 54.5 | 45    | 84.5  |
| 1/2"   | RA290BS-12-8  | 3/4"     | 41.3 | 10   | 54.5 | 53    | 84.5  |
| 3/4"   | RA290BS-12    | 3/4"     | 41.3 | 15.5 | 64   | 61    | 103   |
| 3/4"   | RA290BS-16-12 | 1"       | 47.6 | 15.5 | 64.5 | 67    | 103.5 |
| 1"     | RA290BS-16    | 1"       | 47.6 | 20   | 74.5 | 73    | 127   |
| 1"     | RA290BS-20-16 | 1.1/4"   | 54   | 20   | 74.5 | 80    | 127   |
| 1.1/4" | RA290BS-20    | 1.1/4"   | 54   | 26   | 88.5 | 91    | 148.5 |
| 1.1/4" | RA290BS-24-20 | 1.1/2"   | 63.5 | 26   | 88.5 | 99.5  | 148.5 |
| 1.1/2" | RA290BS-24    | 1.1/2"   | 63.5 | 32   | 108  | 107.5 | 178   |
| 2"     | RA290BS-32    | 2"       | 79.4 | 44   | 134  | 132   | 208.5 |
|        |               |          |      |      |      |       |       |
|        |               |          |      |      |      |       |       |
|        |               |          |      |      |      |       |       |
|        |               |          |      |      |      |       |       |
|        |               |          |      |      |      |       |       |



[www.hydrofer.com](http://www.hydrofer.com)

▶ **BARCELONA**

Avda. de la Fama, 32  
Pol. Ind. Almeda  
08940 CORNELLÀ DE LLOBREGAT

Tel. 93.475.20.00  
Fax. 93.474.44.49

[comercial@hydrofer.com](mailto:comercial@hydrofer.com)

▶ **MADRID**

Tel. 91.380.25.56  
Fax. 91.380.36.47

[madrid@hydrofer.com](mailto:madrid@hydrofer.com)

▶ **VALENCIA**

Bernat y Descoll, 61 bjs  
46026 VALENCIA

Tel. 96.334.81.35  
Fax. 96.334.80.97

[valencia@hydrofer.com](mailto:valencia@hydrofer.com)